

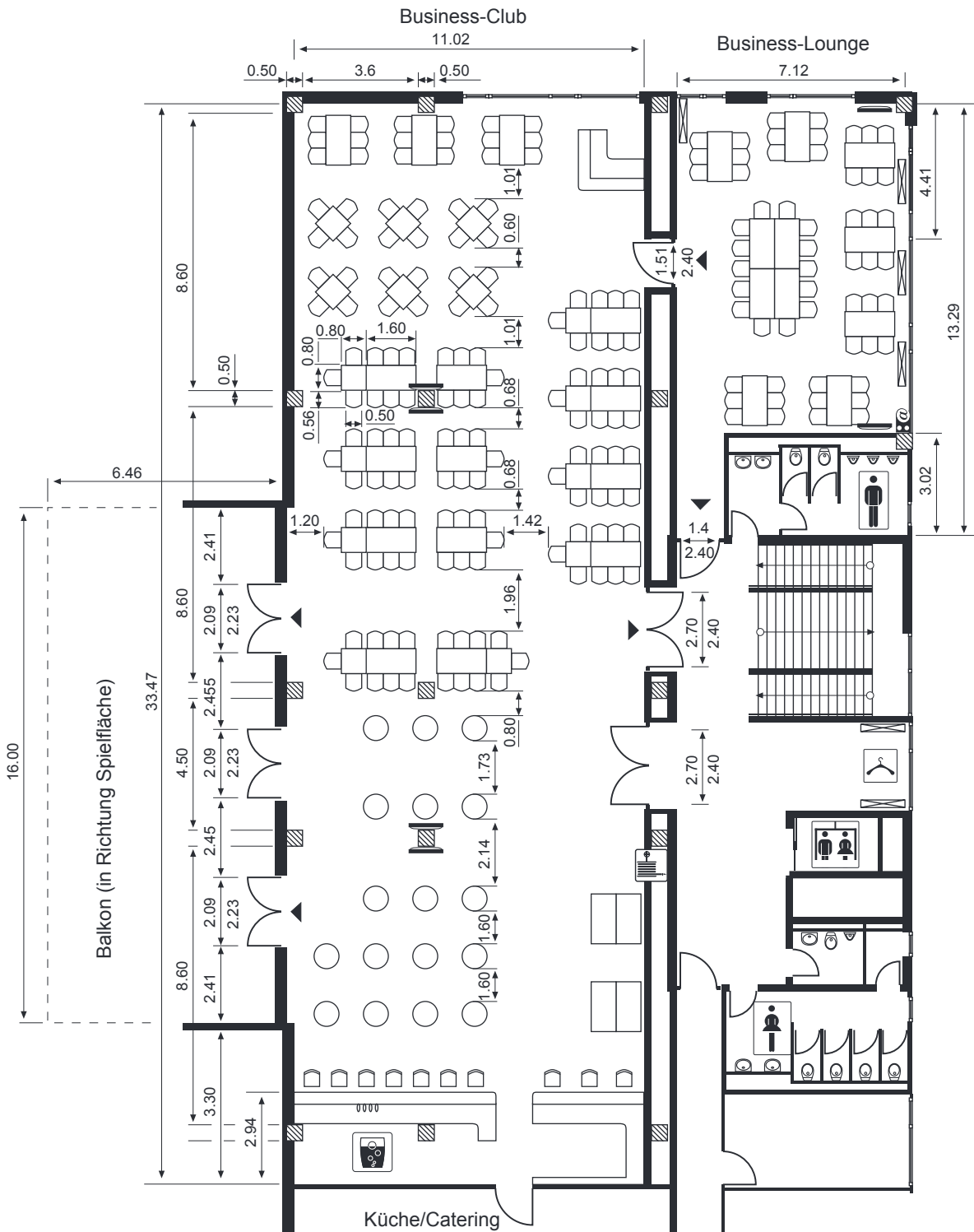





Die MDCC-Arena – Ebene 1/Business-Club, Business-Lounge, Bestuhlungsplan
(Tafeln - Variante 1)

Kapazität

| | | | | | | | | |
|---------------|----------|---|------------|-----------------|----------|---|---------------|--|
| Business-Club | 9 Tische | a | 9 Plätze | Business-Lounge | 7 Tische | a | 6 Plätze | |
| | 3 Tische | a | 7 Plätze | | 1 Tafel | a | 14 Plätze | |
| | 3 Tische | a | 6 Plätze | | | | | |
| | 6 Tische | a | 4 Plätze | | | | | |
| | | | 144 Plätze | | | | 56 Plätze | |
| | | | | Gesamt | | | 200 Plätze | |
| | | | | | | | 97 Stehplätze | |
| | | | | | | | 297 Plätze | |



-  Pfeiler (0,50 m x 0,50 m)
-  Garderobe (mobil)
-  Wandhydrant
-  Heizkörper
-  TV
-  Anschlüsse für Medien

